

AMX240

Audio Selector Panel w/Marker Beacon and 6-place VOX Intercom



Audio Selection & More

Avidyne's AMX240 is a full-featured audio source selector panel, intercom, and Marker Beacon receiver designed to meet the needs of modern Part 23 aircraft and piloted, remotely-piloted, and autonomous Advanced Air Mobility (AAM) aircraft including electric, hybrid Vertical Take Off and Landing (eVTOL).

The panel-mounted AMX240 provides outstanding features and sound quality, while incorporating Avidyne's legendary "Flying Made Simple" user interface. Large, easy-to-read, LED backlit buttons provide simple mode selection and at-a-glance annunciation of your current audio and intercom configuration.

Supporting three transmitter inputs, nine receiver inputs, plus two inputs for stereo music and five unswitched inputs, the AMX240 also features a six-place high-fidelity stereo intercom, public address (PA) function, plus Bluetooth® music and full-duplex cell phone interfaces.

Feature Rich

Dual radio monitor (MON) capability allows the pilot to listen to Standby frequencies on the IFD-Series VHF radios with automatic muting when active frequency is in use. A dedicated Replay button provides a "say again" function that repeats previous ATC communications, and a dedicated Split button allows the pilot to transmit on Com 1 while the Copilot transmits on Com 2.

Six-Place Audio Intercom with Isolation

The AMX240 features a pilot-selectable stereo or mono, six-place intercom system with automatic voice-activated (VOX) squelch for each mic input.

Pilot, crew, and passenger isolation settings are easily selectable with a single dedicated button, and are graphically displayed for clear mode annunciation.

Dedicated knobs for Pilot, Copilot and Passenger intercom volumes allow for full customization for personal preferences without relying on headset volume controls.

QUANTUM

By AVIDYNE

AMX240 Audio Selector Panel w/6-place VOX Intercom

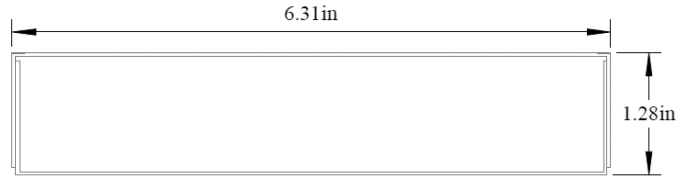

Specifications

AMX240

Weight: 1.95lbs (0.87kg) (w/Rack)

Height: 1.30" (33mm)

Width: 6.30" (160mm)

Depth: 7.12" (180mm)

Power Requirements

Power: 11-33vdc

2.5A @ 28vdc

Environmental

DO160G qualified

- To 35,000ft
- -20 ° C to +55°C

Cooling

No external cooling required

Speaker Power

3 Watts @ 14VDC into 4 Ohms

10 Watts @ 28VDC into 4 Ohms

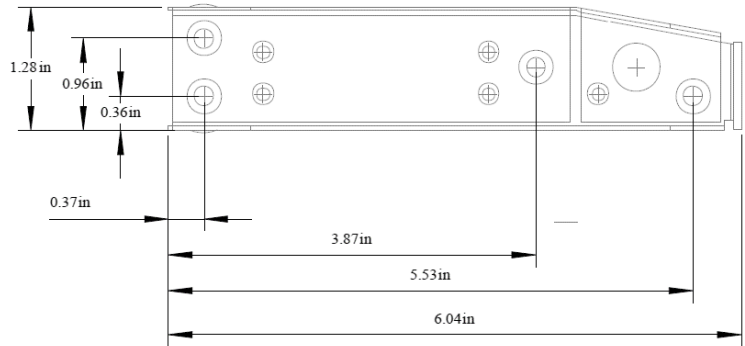

I/O

QTY

Receivers 9 (Com 1, Com 2, Mon 1, Mon 2 Nav 1, Nav 2, Mkr, Aux, Tel)

Xmitter Selections 4 (Com 1, Com 2, Tel, Com ½)

Music Inputs 2

Unswitched 5

Intercom 6 place VOX

Bluetooth 1

Compliance

DO-178: DAL D

DO-254: DAL C

DO-160: A1D1, C, A, B, SU, X, X, X, X, X, X, Z, B, A, B, A, T, B, X, X, E2, X, X, X

TSOs: TSO-C59c, C35d Class A

Avidyne Corporation

710 North Drive

Melbourne, FL 32934

+1.321.751.8520

www.avidyne.com/quantum

Avidyne reserves the right to make changes to product specifications and design features without notice.

QUANTUM